



MEETINGS & EVENTS

---





AN OASIS OF LUXURY  
*in the Heart of London*

---

Beautiful banqueting suites and majestic ballrooms have made the hotel a coveted venue for impressive events, spectacular gatherings and breath-taking weddings up to 650 people. The Landmark London is the perfect venue with its 11 meeting and event spaces over 22,000 square feet (2,100 square metres).











# CONTENTS

ROOM CAPACITIES	04
ROOM DIMENSIONS	05
GRAND BALLROOM	06
GRAND BALLROOM I	08
GRAND BALLROOM II	09
MARBLE BALLROOM	10
CHAMPAGNE ROOM	11
DRAWING ROOM	12
EMPIRE ROOM	13
TOWER SUITE	14
LANDMARK ROOMS & INTERVIEW SUITE	17
RESTAURANTS & BARS	18
ROOMS & SUITES	28
SPA & WELLNESS	30
DIRECTIONS & LOCAL ATTRACTIONS	32
GET IN TOUCH	34

# ROOM CAPACITIES

	REC. DRINKS	LUN/ DIN	DINNER & DANCE	SIT DOWN BUFFET	STAND BUFFET	DRINKS & DINNER		THEATRE	CLASSROOM	CABARET	BOARDROOM	U SHAPE
						<i>no dance floor</i>	<i>dance floor</i>	<i>BP</i>	<i>BP/slims</i>	<i>BP</i>	<i>FP</i>	<i>FP</i>
Grand Ballroom	650	504	432	396	500	252	216	512	266/ 336	264	N/A	N/A
Grand Ballroom I	300	240	180	180	250	120	74	210	105/ 119	112	42	50
Grand Ballroom II	300	240	180	180	250	120	74	210	105/ 119	112	42	50
Marble Ballroom	500	408	348	324	400	204	144	300	176/ 190	160	N/A	N/A
Champagne Room	70	36	N/A	36	40	24	N/A	70	30	24	24	20
Drawing Room	300	180	132	132	200	96	72	120	70/90	72	40	30
Empire Room	250	168	120	120	180	84	60	180	100/ 120	88	40	40
Tower Suite	70	36	N/A	36	40	36	N/A	36	21	24	25	20
Champagne Bar	250	120	N/A	120	200	N/A	N/A	N/A	N/A	N/A	N/A	N/A
Landmark I	15	10	N/A	12	12 WL	12 oval	N/A	21	N/A	N/A	10	N/A
Landmark II	40	36	N/A	24	30 WL	24	N/A	36	21	24	20	18
Landmark III	40	36	N/A	24	30	24	N/A	36	21	24	20	18
Landmark II & III	80	72	N/A	60	75	50	N/A	70	42	42	42	36

# ROOM DIMENSIONS

	Width		Length		Chandelier Height		Max Height		Areas	
ROOMS	Metres	Feet	Metres	Feet	Metres	Feet	Metres	Feet	Metres	Feet
GRAND BALLROOM	13.59	44'6	42.90	144'	4.00	13'2"	5.49	18'	610	6565
MARBLE BALLROOM	13.50	44'5"	35.77	117'3	3.32	10'11"	6.25	20'6"	478	5145
MARBLE HALL	7	23'0"	29	95'14"	-	-	2.71	8'10"	201	2163
DRAWING ROOM	12.86	42'2"	21.44	70'4"	3.7	12'1"	6.35	20'	254	2734
GRAND BALLROOM I	13.59	44'6"	21.81	71'6"	4	13'2"	5.49	18'	318	3422
GRAND BALLROOM II	13.59	44'6"	21.10	69'3"	4	13'2"	5.49	18'	292	3143
EMPIRE ROOM	7.82	25'7"	26.05	85'5"	3.6	11'10"	6.23	20'5"	222	2389
TOWER SUITE	6.59	21'7"	12.9	23'7"	-	-	9.11	29'11"	57	613
CHAMPAGNE ROOM	7.81	25'7"	10.06	33'	2.66	8'6"	3.86	12'7"	81	871
LANDMARK 1	5.43	17'9"	10.93	35'10"	-	-	2.38	7'10"	49	527
LANDMARK 2	6.95	22'10"	8.23	27'	-	-	2.38	7'10"	54	581
LANDMARK 3	6.95	22'10"	7.92	26	-	-	2.38	7'10"	57	613
LANDMARK 2 & 3	6.95	22'10"	16.15	53	-	-	2.38	7'10"	111	1194
INTERVIEW SUITE	2.5	8.2	6.9	22.64	-	-	2.38	7'10"	16	172



# GRAND BALLROOM - GROUND FLOOR



*This beautiful room provides an extensive area with high ceilings and natural lighting for large catering events and wedding receptions. The room can be divided into two separate rooms - Grand Ballroom I & II*

## DIMENSIONS

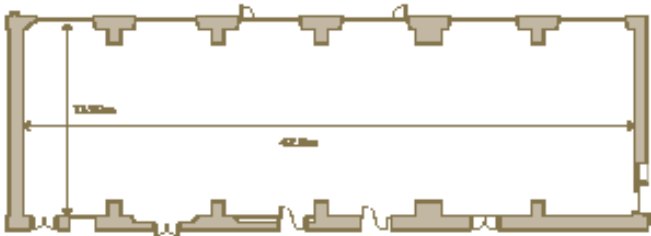

## DINNER / DANCE

Capacity: 432 Rounds of 12

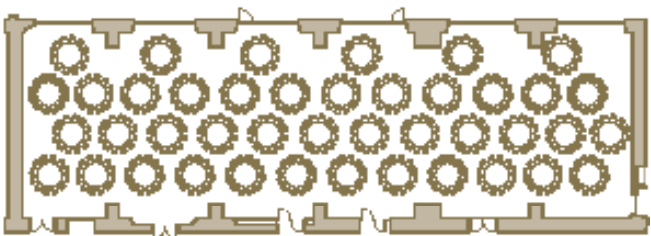

# GRAND BALLROOM - GROUND FLOOR



## CLASSROOM

Capacity: 336

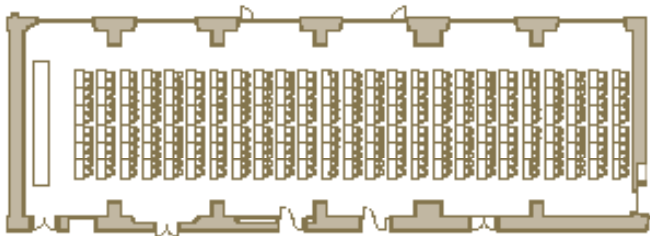

## THEATRE

Capacity: 512

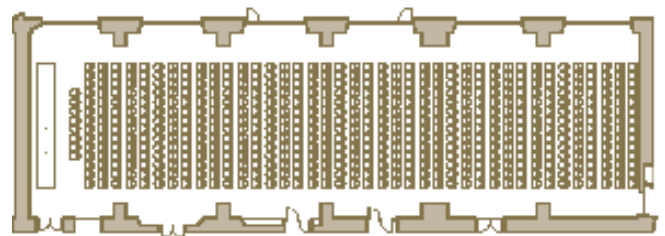



# GRAND BALLROOM I

---



*Medium-sized function rooms of distinctive identity and charm with beautiful chandeliers and high ceilings.*

---

## LUNCH / DINNER

Capacity: 240 Rounds of 12

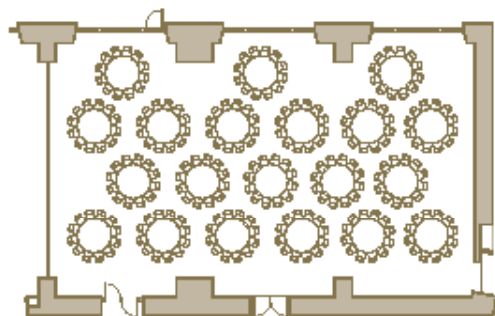

---

## CLASSROOM

Capacity: 119

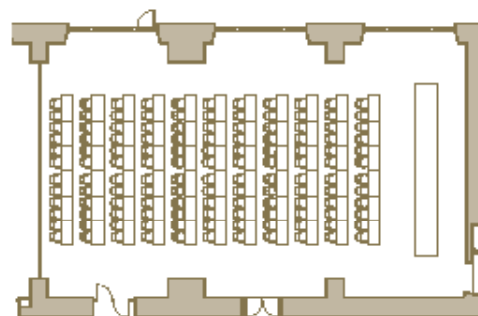



# GRAND BALLROOM II



LUNCH / DINNER  
Capacity: 240 Rounds of 12

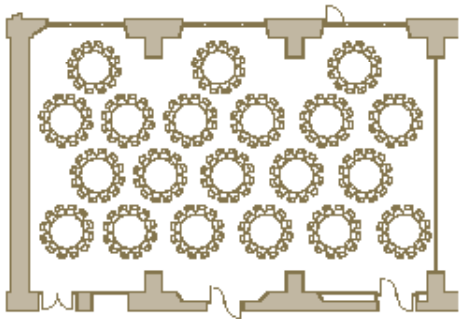

THEATRE  
Capacity: 210

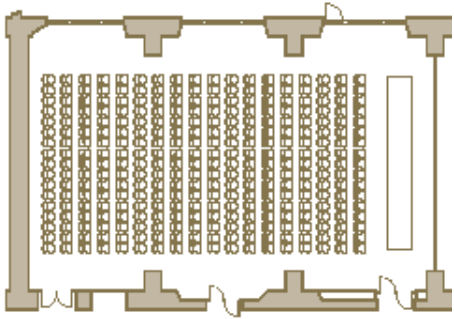

# MARBLE BALLROOM - GROUND FLOOR

---



*Ideal venue for large gatherings and drink receptions and it is interconnected and included with the Champagne Room.*

---

## DINNER / DANCE

Capacity: 408 Rounds of 12

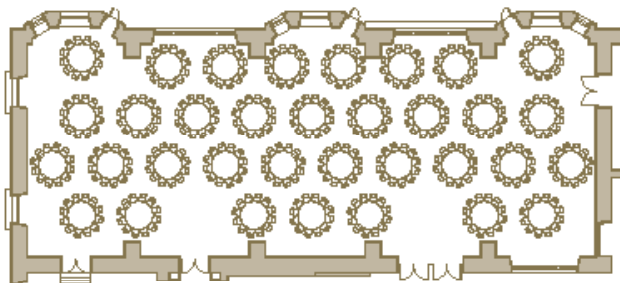

---

## CLASSROOM

Capacity: 190

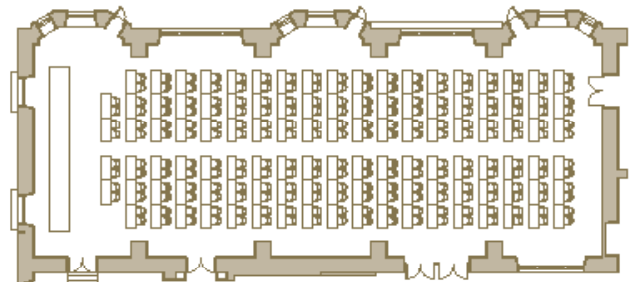



# MARBLE BALLROOM - GROUND FLOOR



## CHAMPAGNE ROOM GROUND FLOOR

*Included complimentary with the Marble Ballroom.  
Can be used as a green room, storage room or event team room.*

DRINKS RECEPTION  
Capacity: 70

THEATRE PLAN  
Capacity: 70

LUNCH / DINNER  
Capacity: 36

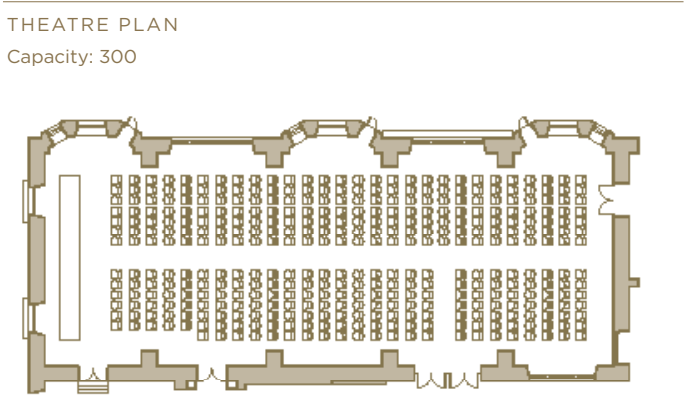



## DRAWING ROOM - GROUND FLOOR

---



*Featuring beautiful wood paneling and other distinctive architectural elements.  
Located close to the Marble Ballroom.*

---

### CLASSROOM

Capacity: 90

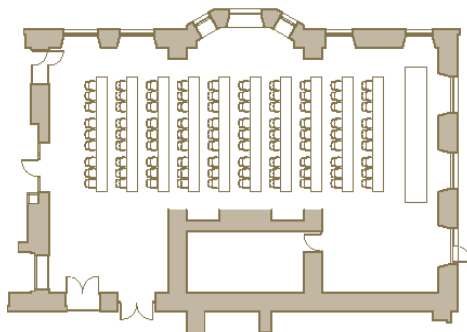

---

### LUNCH / DINNER

Capacity: 180 Rounds of 12

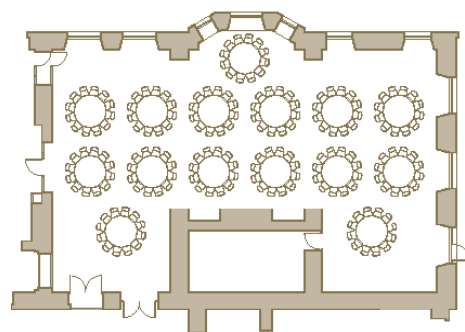

## EMPIRE ROOM - GROUND FLOOR

---



*A charming room with north and west facing floor length windows and high ceilings.  
Located next to the Grand Ballroom.*

---

### THEATRE

Capacity: 180

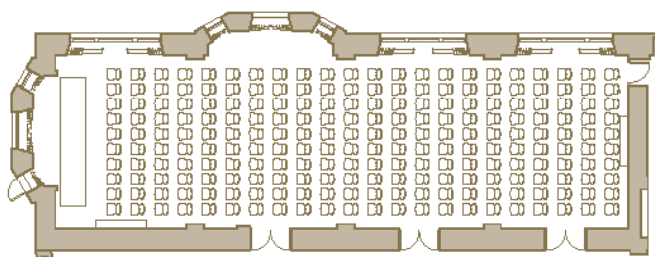

---

### LUNCH / DINNER

Capacity: 168 Rounds of 12

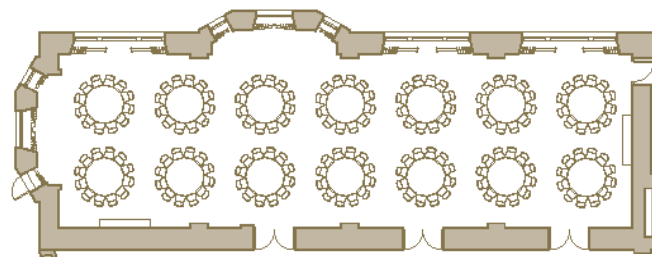



## TOWER SUITE - 5TH FLOOR

---



*Take in the breathtaking view of the atrium from the large floor-to-ceiling windows, and the abundance of natural light from the glass ceiling feature, providing a view of the clock tower.*



# TOWER SUITE - 5TH FLOOR



*The Tower Suite comes with two additional rooms suitable for cloakroom area and drinks receptions.*

## THEATRE

Capacity: 36

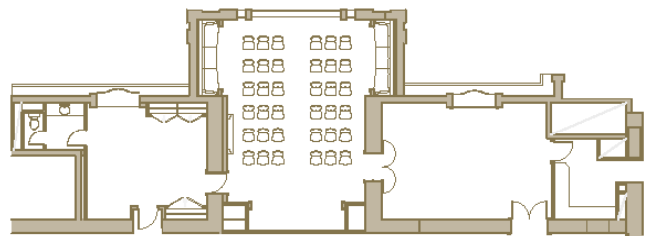

## LUNCH / DINNER

Capacity: 36 Rounds of 12

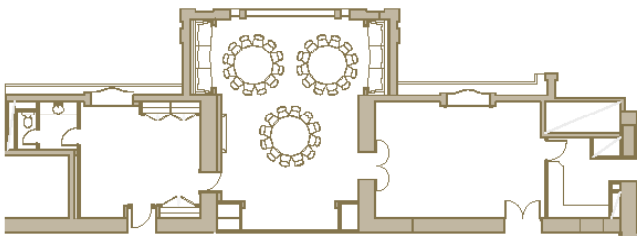



# LANDMARK ROOMS & INTERVIEW SUITE

*Ideal for small meetings, private dining and interviews. Landmark 2 & 3 are interconnecting.*

## Landmark 1

THEATRE  
Capacity: 21

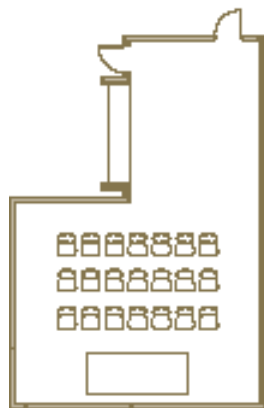

## Interview Suite

BOARDROOM  
Capacity: 6

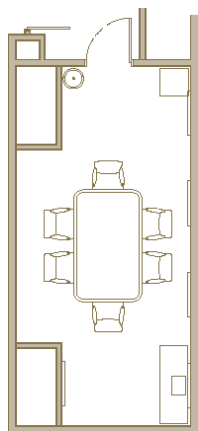

## Landmark 2

THEATRE  
Capacity: 36



## Landmark 2

CLASSROOM  
Capacity: 21



## Landmark 3

THEATRE  
Capacity: 36



## Landmark 3

CLASSROOM  
Capacity: 21





# RESTAURANTS & BARS

---





*Experience modern European dining in this enchanting setting under a magnificent glass roofed atrium. Available for small group dining in semi-private area up to 16 people.*





## RESTAURANTS & BARS

---

### CHAMPAGNE BAR

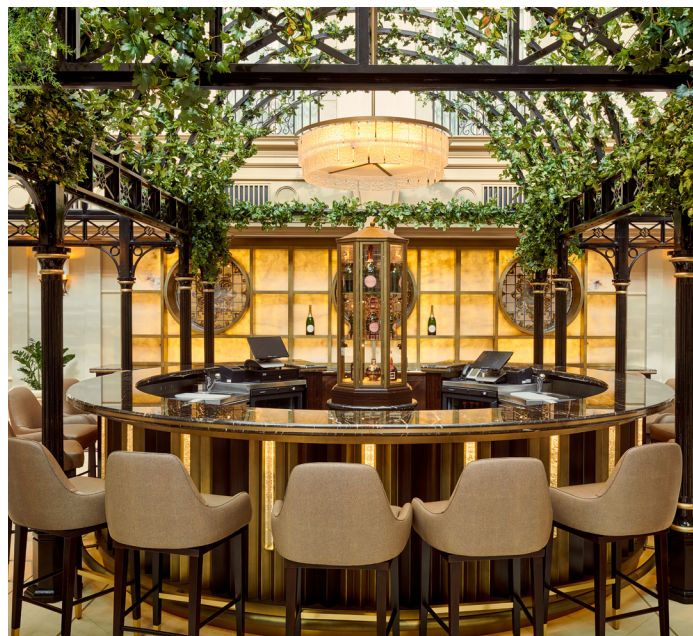



*Tucked away under a botanic horizon, uncover the bustling Champagne Bar in our oasis of luxury.  
Available for private hire up to 250 people standing for drinks and canapés.*

---





# RESTAURANTS & BARS

## GREAT CENTRAL

PUB  
BY MATT FLETCHER





*Great Central Pub by Matt Fletcher, a British gastro pub in the heart of Marylebone.  
Available to private hire up to 100 people and entertainment can be arranged.*

---





# RESTAURANTS & BARS

---

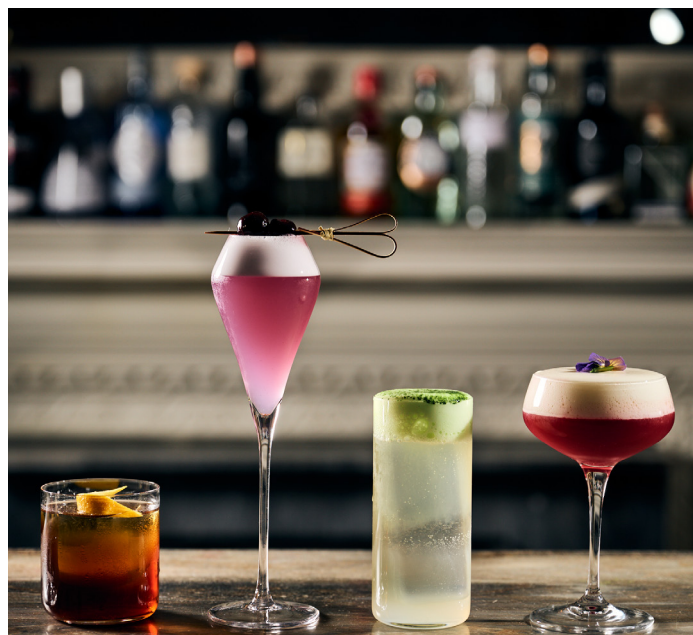



*Revel in the glamorous ambiance of a secret London hideaway.*





# WEDDINGS

---





*A leading London venue with grand and elegant spaces for all types and sizes of weddings.*

---





# ROOMS & SUITES

---





*Retreat from the vibrant city and relax in the peaceful luxury of one of our spacious rooms and suites.*



LANDMARK SIGNATURE SUITE - 110 sqm



# SPA & WELLNESS

---



*Escape to a blissful place and discover a secret hideaway in the heart of London.*

---





# DIRECTIONS & LOCAL ATTRACTIONS

## The Landmark London

222 Marylebone Road, London, NW1 6JQ

## Travelling From

- WEST

M40 to Marylebone Road
- EAST

M25 to M40, to Marylebone Road
- NORTH

M1 to Edgware Road, turn left on to Marylebone Road
- SOUTH

M25 to M40, to Marylebone Road

## Directions From Heathrow Airport

Heathrow Airport is situated 14 miles west of London.

## By Car

Take the M4 (which leads on to the A4) to the M25. Continue until the A40 (M40) and then turn right into Marylebone Road.

## By Rail

Using Heathrow Express takes 15 minutes to Paddington Station. From Paddington Station, The Landmark is 5 minutes by taxi, or two stops by tube to Marylebone Station.

## Directions From Gatwick Airport

Thameslink trains run from Gatwick to Kings Cross Thameslink station, Kings Cross Thameslink Station is a 15-minute taxi ride from The Landmark London. Alternatively, the Gatwick Express terminates at Victoria Station, which is 15-minute taxi ride from The Landmark London.

NB: The Landmark London is located on Marylebone Road, at the border of London's Congestion Charge region. If travelling by car, pass by central London in order to avoid this charge.

Madame Tussauds [www.madame-tussauds.co.uk](http://www.madame-tussauds.co.uk)

 9 mins



 5 mins



 Baker Street

Marylebone High Street [www.marylebonevillage.com](http://www.marylebonevillage.com)

 13 mins



 6 mins



 Marlylebone

Wallace Collection [www.wallacecollection.org](http://www.wallacecollection.org)

 14 mins



 7 mins



 Baker Street

Regents Park Open Air Theatre [www.openairtheatre.com](http://www.openairtheatre.com)

 15 mins



 8 mins



 Regent's Park

Selfridges [www.selfridges.com](http://www.selfridges.com)

 18 mins



 8 mins



 Bond Street

Bond Street Shopping [www.bondstreet.co.uk](http://www.bondstreet.co.uk)

 21 mins



 9 mins



 Bond Street

Lords Cricket Ground [www.lords.org](http://www.lords.org)

 23 mins



 5 mins



 St John's Wood

Oxford Street & Regent Street [www.oxfordstreet.co.uk](http://www.oxfordstreet.co.uk)

 25 mins



 11 mins



 Oxford Circus

London Zoo [www.zsl.org](http://www.zsl.org)

 30 mins



 7 mins



 Camden Town

Camden Market [www.camdenmarket.com](http://www.camdenmarket.com)

 39 mins



 13 mins



 Camden Town

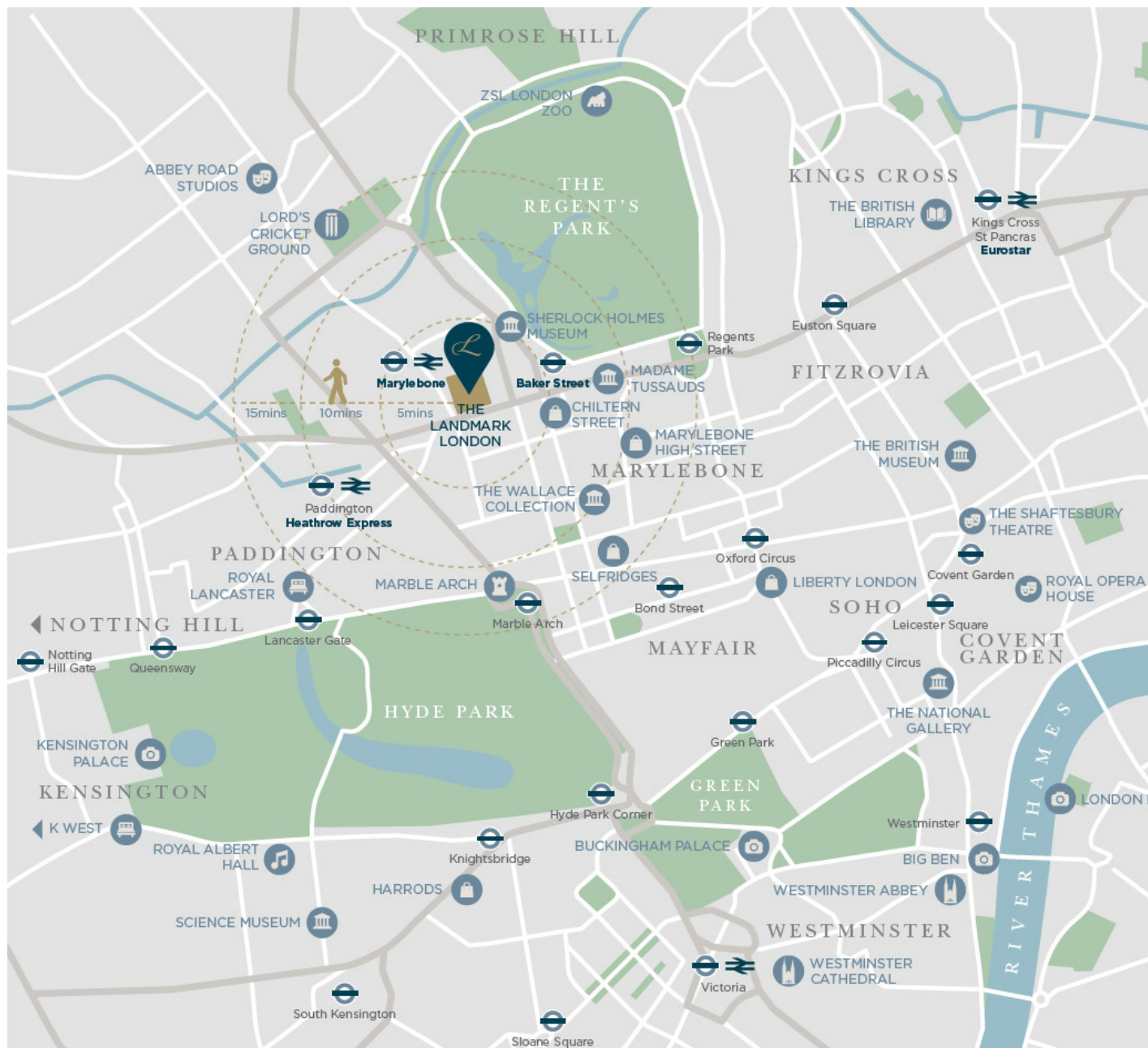



# GET IN TOUCH

The hotel is situated directly opposite and  
connected to Marylebone Station at:

The Landmark London  
222 Marylebone Road  
London  
NW1 6JQ

Tel: +44 (0) 20 7631 8000

Fax: +44 (0) 20 7631 8080

Email: [event.sales@thelandmark.co.uk](mailto:event.sales@thelandmark.co.uk)

[www.landmarklondon.co.uk](http://www.landmarklondon.co.uk)









THE LANDMARK LONDON

222 Marylebone Road, London, NW1 6JQ

Tel: +44 (0) 20 7631 8000 Email: [event.sales@thelandmark.co.uk](mailto:event.sales@thelandmark.co.uk)

[www.landmarklondon.co.uk](http://www.landmarklondon.co.uk)