



The
Landmark
LONDON

MEETINGS & EVENTS





AN OASIS OF LUXURY
in the Heart of London

Beautiful banqueting suites and majestic ballrooms have made the hotel a coveted venue for impressive events, spectacular gatherings and breath-taking weddings up to 650 people. The Landmark London is the perfect venue with its 11 meeting and event spaces over 22,000 square feet (2,100 square metres).







CONTENTS

HOTEL FLOOR PLAN	07
ROOM CAPACITIES	08
ROOM DIMENSIONS	09
GRAND BALLROOM	10
GRAND BALLROOM I	12
GRAND BALLROOM II	13
MARBLE BALLROOM	14
CHAMPAGNE ROOM	15
DRAWING ROOM	16
EMPIRE ROOM	17
TOWER SUITE	18
CHAMPAGNE BAR	19
LANDMARK ROOMS	20
LANDMARK ROOMS & INTERVIEW SUITE	21
RESTAURANTS & BARS	22
WEDDINGS	30
ROOMS & SUITES	32
SPA & WELLNESS	34
DIRECTIONS & LOCAL ATTRACTIONS	36
GET IN TOUCH	38



HOTEL FLOOR PLAN

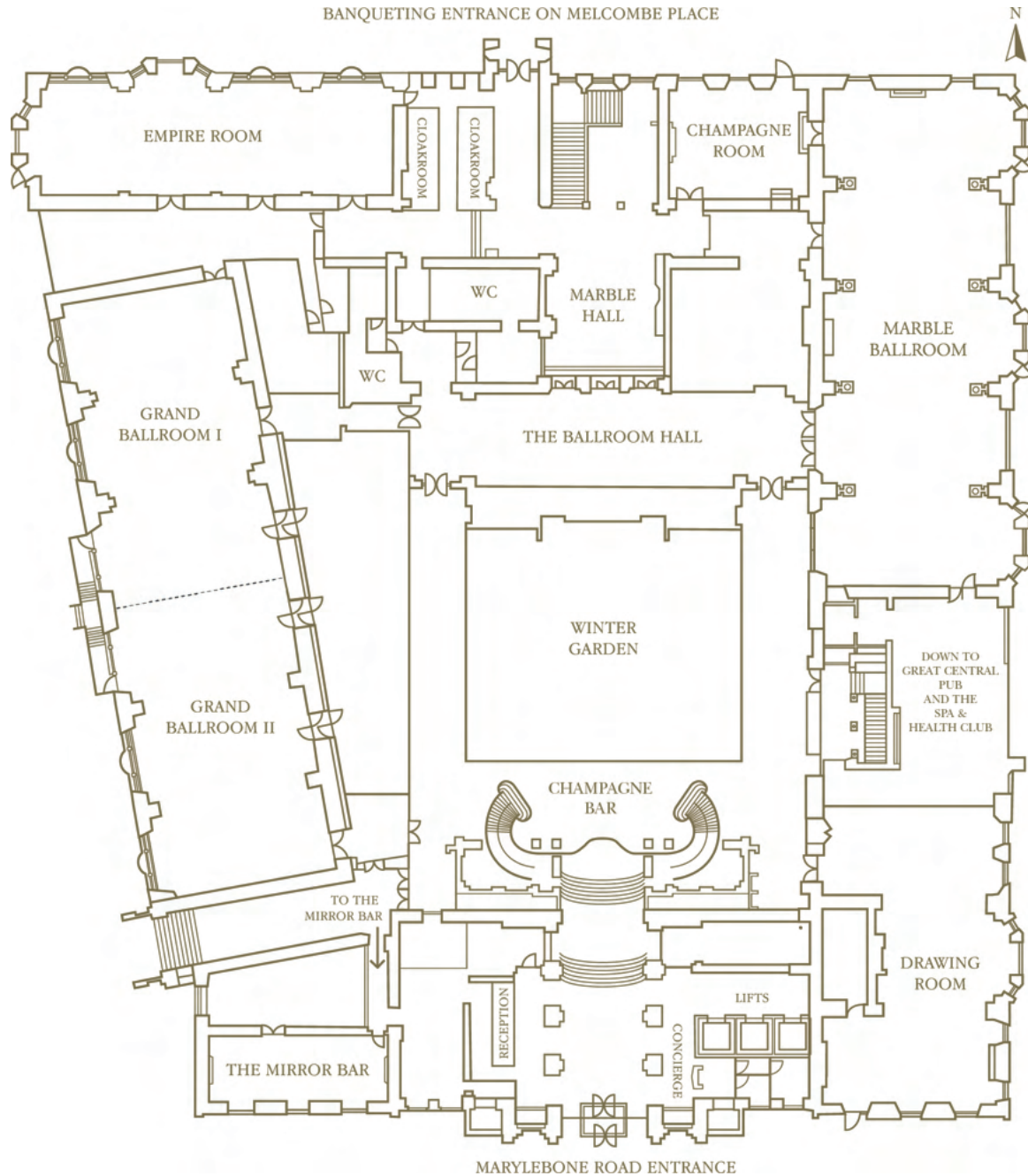

ROOM CAPACITIES

	REC. DRINKS	LUN/ DIN	DINNER & DANCE	SIT DOWN BUFFET	STAND BUFFET	DRINKS & DINNER		THEATRE	CLASSROOM	CABARET	BOARDROOM	U SHAPE
						<i>no dance floor</i>	<i>dance floor</i>	<i>BP</i>	<i>BP/slims</i>	<i>BP</i>	<i>FP</i>	<i>FP</i>
Grand Ballroom	650	504	432	396	500	252	216	512	266/ 336	264	N/A	N/A
Grand Ballroom I	300	240	180	180	250	120	74	210	105/ 119	112	42	50
Grand Ballroom II	300	240	180	180	250	120	74	210	105/ 119	112	42	50
Marble Ballroom	500	408	348	324	400	204	144	300	176/ 190	160	N/A	N/A
Champagne Room	70	36	N/A	36	40	24	N/A	70	30	24	24	20
Drawing Room	300	180	132	132	200	96	72	120	70/90	72	40	30
Empire Room	250	168	120	120	180	84	60	180	100/ 120	88	40	40
Tower Suite	70	36	N/A	36	40	36	N/A	36	21	24	25	20
Champagne Bar	250	120	N/A	120	200	N/A	N/A	N/A	N/A	N/A	N/A	N/A
Landmark I	15	10	N/A	12	12 WL	12 oval	N/A	21	N/A	N/A	10	N/A
Landmark II	40	36	N/A	24	30 WL	24	N/A	36	21	24	20	18
Landmark III	40	36	N/A	24	30	24	N/A	36	21	24	20	18
Landmark II & III	80	72	N/A	60	75	50	N/A	70	42	42	42	36

ROOM DIMENSIONS

ROOMS	Width		Length		Chandelier Height		Max Height		Areas	
	Metres	Feet	Metres	Feet	Metres	Feet	Metres	Feet	Metres	Feet
GRAND BALLROOM	13.59	44'6"	42.90	144'	4.00	13'2"	5.49	18'	610	6565
MARBLE BALLROOM	13.50	44'5"	35.77	117'3"	3.32	10'11"	6.25	20'6"	478	5145
MARBLE HALL	7	23'0"	29	95'14"	-	-	2.71	8'10"	201	2163
DRAWING ROOM	12.86	42'2"	21.44	70'4"	3.7	12'1"	6.35	20'	254	2734
GRAND BALLROOM I	13.59	44'6"	21.81	71'6"	4	13'2"	5.49	18'	318	3422
GRAND BALLROOM II	13.59	44'6"	21.10	69'3"	4	13'2"	5.49	18'	292	3143
EMPIRE ROOM	7.82	25'7"	26.05	85'5"	3.6	11'10"	6.23	20'5"	222	2389
TOWER SUITE	6.59	21'7"	12.9	23'7"	-	-	9.11	29'11"	57	613
CHAMPAGNE ROOM	7.81	25'7"	10.06	33'	2.66	8'6"	3.86	12'7"	81	871
LANDMARK 1	5.43	17'9"	10.93	35'10"	-	-	2.38	7'10"	49	527
LANDMARK 2	6.95	22'10"	8.23	27'	-	-	2.38	7'10"	54	581
LANDMARK 3	6.95	22'10"	7.92	26'	-	-	2.38	7'10"	57	613
LANDMARK 2 & 3	6.95	22'10"	16.15	53'	-	-	2.38	7'10"	111	1194
INTERVIEW SUITE	2.5	8.2	6.9	22.64	-	-	2.38	7'10"	16	172

GRAND BALLROOM - GROUND FLOOR



This beautiful room provides an extensive area with high ceilings and natural lighting for large catering events and wedding receptions. The room can be divided into two separate rooms - Grand Ballroom I & II

DIMENSIONS

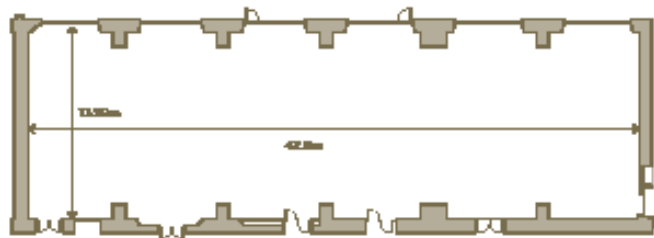

DINNER / DANCE

Capacity: 432 Rounds of 12

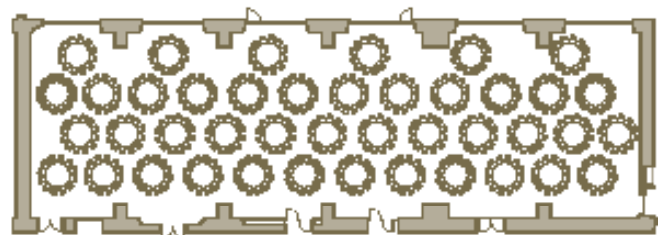

GRAND BALLROOM - GROUND FLOOR



CLASSROOM

Capacity: 336

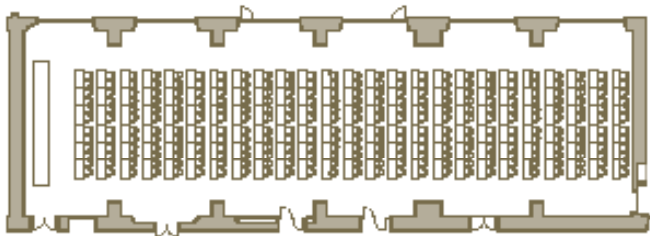

THEATRE

Capacity: 512

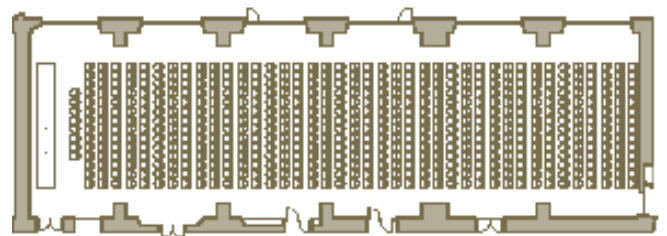

GRAND BALLROOM I



Medium-sized function rooms of distinctive identity and charm with beautiful chandeliers and high ceilings.

LUNCH / DINNER

Capacity: 240 Rounds of 12

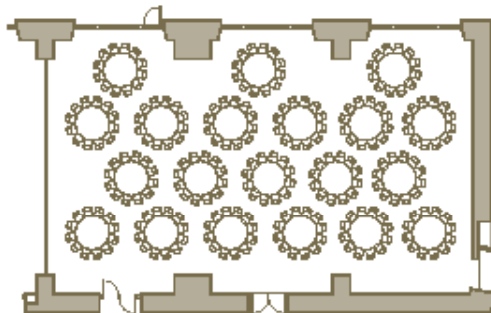

CLASSROOM

Capacity: 119

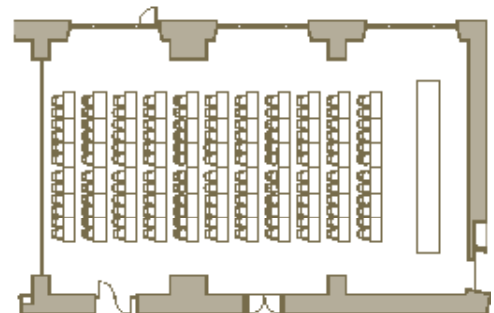

GRAND BALLROOM II



LUNCH / DINNER

Capacity: 240 Rounds of 12

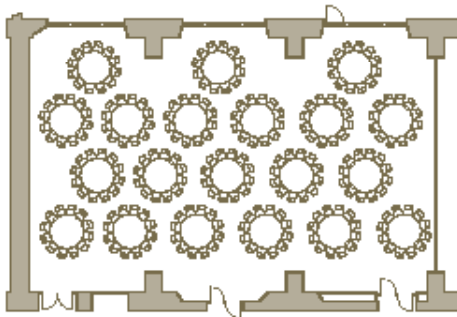

THEATRE

Capacity: 210

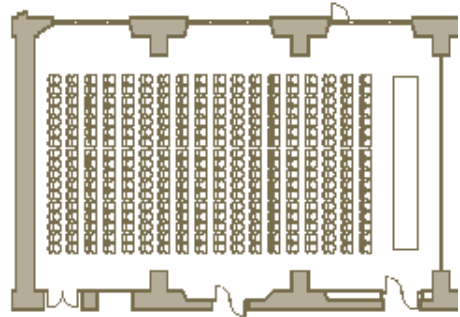

MARBLE BALLROOM - GROUND FLOOR



Ideal venue for large gatherings and drink receptions and it is interconnected and included with the Champagne Room.

DINNER / DANCE

Capacity: 408 Rounds of 12

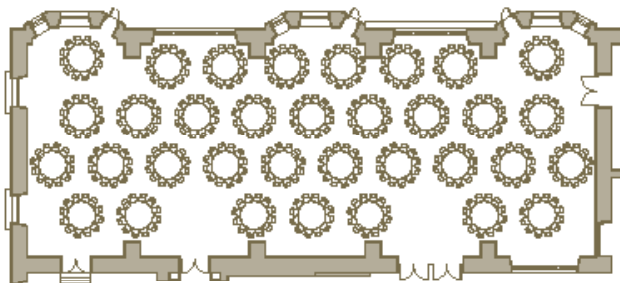

CLASSROOM

Capacity: 190

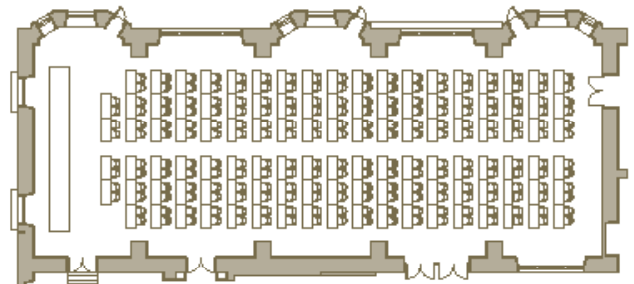

MARBLE BALLROOM - GROUND FLOOR



CHAMPAGNE ROOM GROUND FLOOR

*Included complimentary with the Marble Ballroom.
Can be used as a green room, storage room or event team room.*

DRINKS RECEPTION

Capacity: 70

THEATRE PLAN

Capacity: 70

LUNCH / DINNER

Capacity: 36

THEATRE PLAN

Capacity: 300

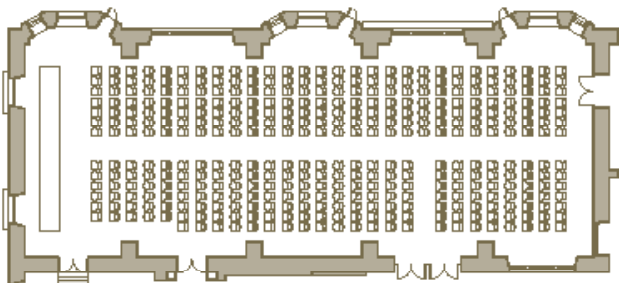

DRAWING ROOM - GROUND FLOOR



*Featuring beautiful wood paneling and other distinctive architectural elements.
Located close to the Marble Ballroom.*

CLASSROOM

Capacity: 90

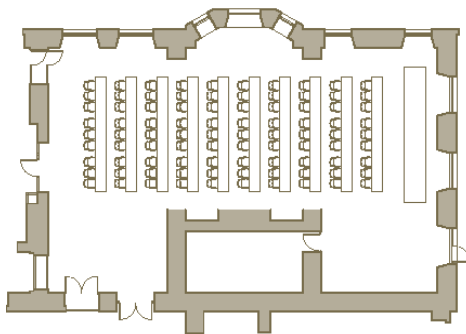

LUNCH / DINNER

Capacity: 180 Rounds of 12

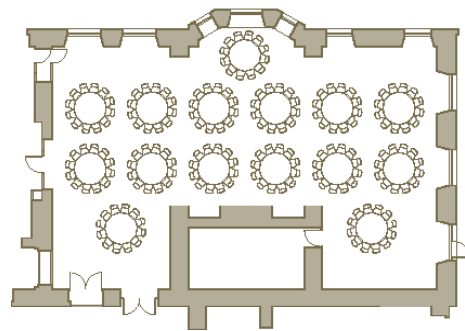

EMPIRE ROOM - GROUND FLOOR



*A charming room with north and west facing floor length windows and high ceilings.
Located next to the Grand Ballroom.*

THEATRE

Capacity: 180

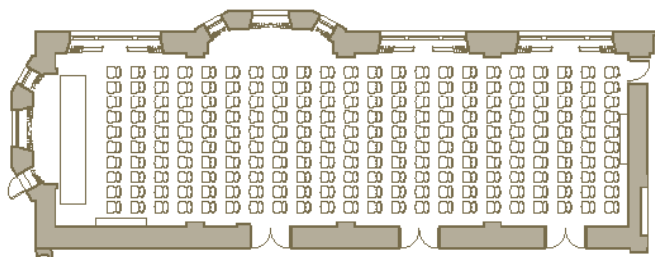

LUNCH / DINNER

Capacity: 168 Rounds of 12

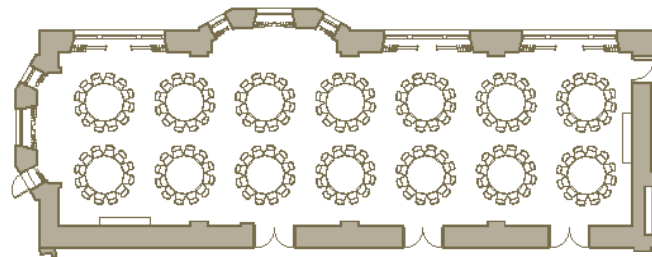

TOWER SUITE - 5TH FLOOR



Take in the breathtaking view of the atrium from the large floor-to-ceiling windows, and the abundance of natural light from the glass ceiling feature, providing a view of the clock tower.

TOWER SUITE - 5TH FLOOR



The Tower Suite comes with two additional rooms suitable for cloakroom area and drinks receptions.

THEATRE

Capacity: 36

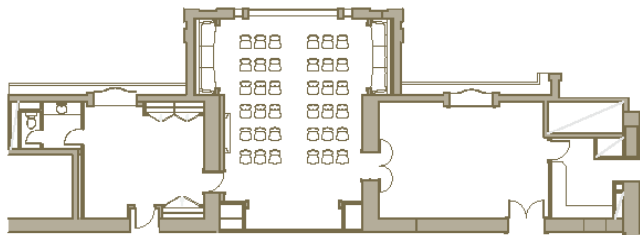

LUNCH / DINNER

Capacity: 36 Rounds of 12

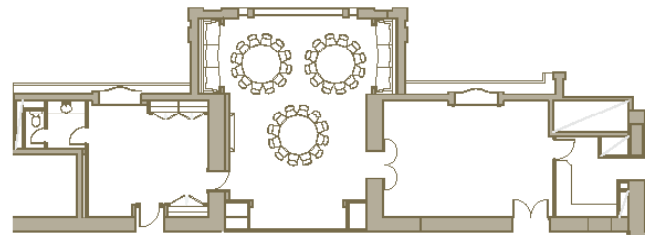



LANDMARK ROOMS & INTERVIEW SUITE

Ideal for small meetings, private dining and interviews. Landmark 2 & 3 are interconnecting.

Landmark 1

THEATRE

Capacity: 21

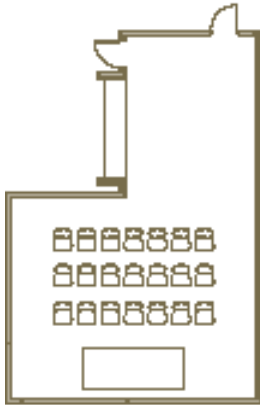

Interview Suite

BOARDROOM

Capacity: 6

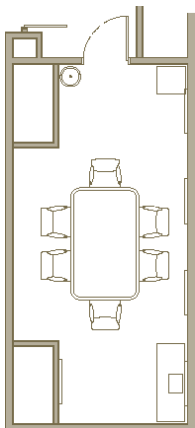

Landmark 2

THEATRE

Capacity: 36



Landmark 2

CLASSROOM

Capacity: 21



Landmark 3

THEATRE

Capacity: 36



Landmark 3

CLASSROOM

Capacity: 21



RESTAURANTS & BARS

WINTER GARDEN RESTAURANT



Experience modern European dining in this enchanting setting under a magnificent glass roofed atrium. Available for small group dining in semi-private area up to 16 people.



RESTAURANTS & BARS

CHAMPAGNE BAR



*Tucked away under a botanic horizon, uncover the bustling Champagne Bar in our oasis of luxury.
Available for private hire up to 250 people standing for drinks and canapés.*



RESTAURANTS & BARS

GREAT CENTRAL

PUB
BY MATT FLETCHER



*Great Central Pub by Matt Fletcher, a British gastro pub in the heart of Marylebone.
Available to private hire up to 100 people and entertainment can be arranged.*



RESTAURANTS & BARS



Revel in the glamorous ambiance of a secret London hideaway.



WEDDINGS



A leading London venue with grand and elegant spaces for all types and sizes of weddings.



ROOMS & SUITES



SUPERIOR ROOM - 32sqm



EXECUTIVE FAMILY ROOM - 55sqm



LANDMARK SUITE - 110sqm



PRESIDENTIAL SUITE - 160sqm

Retreat from the vibrant city and relax in the peaceful luxury of one of our spacious rooms and suites.



EXECUTIVE ROOM - 52sqm

SPA & WELLNESS



Escape to a blissful place and discover a secret hideaway in the heart of London.



DIRECTIONS & LOCAL ATTRACTIONS

The Landmark London

222 Marylebone Road, London, NW1 6JQ

Travelling From

WEST M40 to Marylebone Road
EAST M25 to M40, to Marylebone Road
NORTH M1 to Edgware Road, turn left on to Marylebone Road
SOUTH M25 to M40, to Marylebone Road

Directions From Heathrow Airport

Heathrow Airport is situated 14 miles west of London.

By Car

Take the M4 (which leads on to the A4) to the M25. Continue until the A40 (M40) and then turn right into Marylebone Road.

By Rail

Using Heathrow Express takes 15 minutes to Paddington Station. From Paddington Station, The Landmark is 5 minutes by taxi, or two stops by tube to Marylebone Station.

Directions From Gatwick Airport

Thameslink trains run from Gatwick to Kings Cross Thameslink station, Kings Cross Thameslink Station is a 15-minute taxi ride from The Landmark London. Alternatively, the Gatwick Express terminates at Victoria Station, which is 15-minute taxi ride from The Landmark London.

NB: The Landmark London is located on Marylebone Road, at the border of London's Congestion Charge region. If travelling by car, pass by central London in order to avoid this charge.

Madame Tussauds www.madame-tussauds.co.uk

 9 mins  5 mins  Baker Street

Marylebone High Street www.marylebonevillage.com

 13 mins  6 mins  Marlylebone

Wallace Collection www.wallacecollection.org

 14 mins  7 mins  Baker Street



Regents Park Open Air Theatre www.openairtheatre.com

 15 mins  8 mins  Regent's Park

Selfridges www.selfridges.com

 18 mins  8 mins  Bond Street



Bond Street Shopping www.bondstreet.co.uk

 21 mins  9 mins  Bond Street

Lords Cricket Ground www.lords.org

 23 mins  5 mins  St John's Wood

Oxford Street & Regent Street www.oxfordstreet.co.uk

 25 mins  11 mins  Oxford Circus

London Zoo www.zsl.org

 30 mins  7 mins  Camden Town

Camden Market www.camdenmarket.com

 39 mins  13 mins  Camden Town

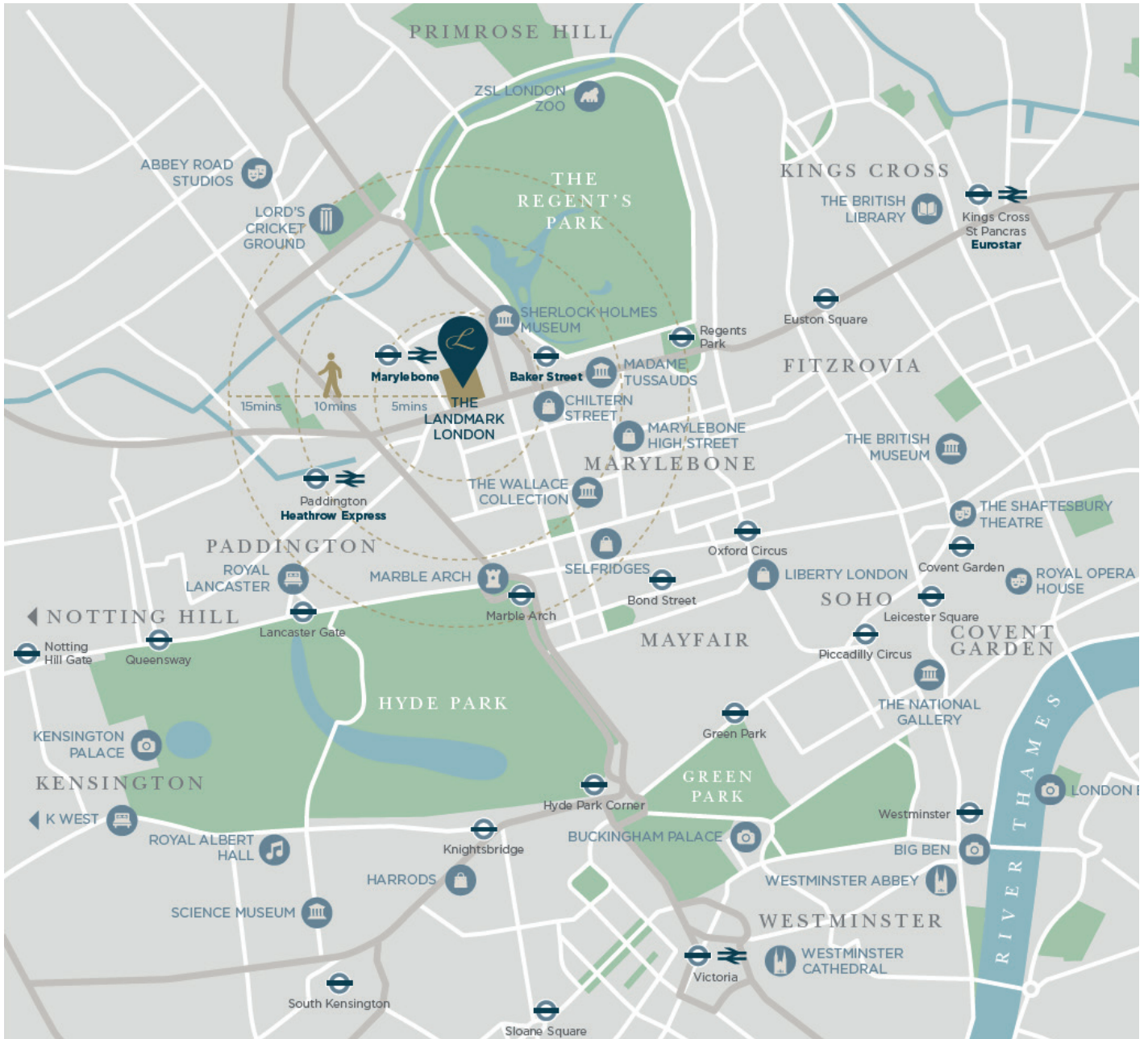

GET IN TOUCH

The hotel is situated directly opposite and connected to Marylebone Station at:

The Landmark London
222 Marylebone Road
London
NW1 6JQ

Tel: +44 (0) 20 7631 8000

Fax: +44 (0) 20 7631 8080

Email: event.sales@thelandmark.co.uk

www.landmarklondon.co.uk





THE LANDMARK LONDON

222 Marylebone Road, London, NW1 6JQ

Tel: +44 (0) 20 7631 8000 Email: event.sales@thelandmark.co.uk

www.landmarklondon.co.uk