

## GRAND BALLROOM |

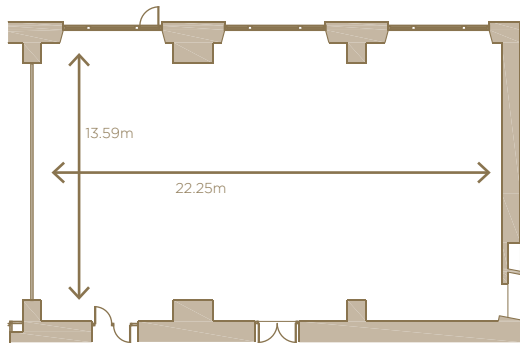

### ROOM CAPACITY

RECEPTION: 350  
LUNCH / DINNER: 240  
DINNER & DANCE: 180  
SIT DOWN BUFFET: 180  
THEATRE: 306  
CLASSROOM: 133  
CABARET: 136  
BOARDROOM: 42  
U-SHAPE: 50

### ROOM FEATURES

- Floor to ceiling windows, natural daylight
- High ceiling: 5.49m (maximum height); 4.00m (chandelier height)
- Dedicated kitchen
- Dedicated Events Manager
- Easy loading access from street
- Cloakroom and registration desk
- Group check-in location
- Space for 3 coaches for guest drop off
- Original ornate architectural detail
- 125 AWP and 63 AWP phase power



**FOR FURTHER INFORMATION PLEASE CONTACT OUR EVENT SALES TEAM:**

*event.sales@thelandmark.co.uk*  
**+44 (0)20 7631 8271**

## GRAND BALLROOM |

### THEATRE LAYOUT

*Capacity: 306*

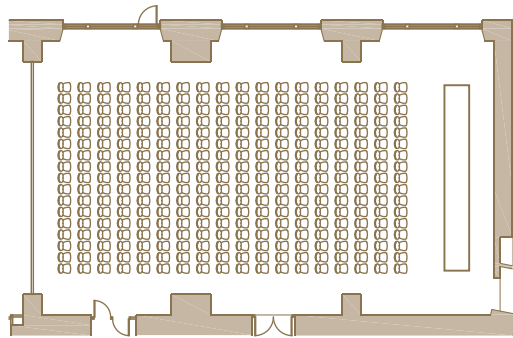

### CLASSROOM LAYOUT

*Capacity: 133*

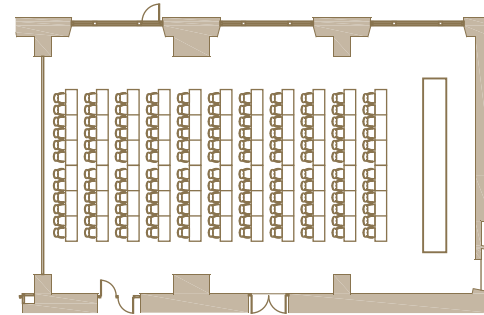

### LUNCH/DINNER LAYOUT

*Capacity: 240*

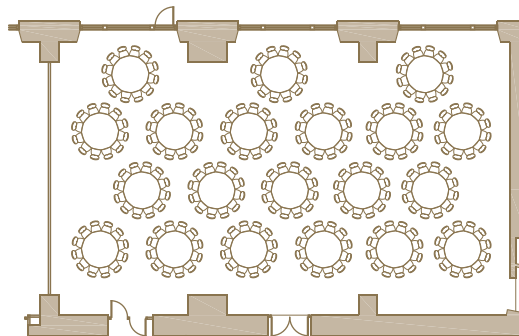

**FOR FURTHER INFORMATION PLEASE CONTACT OUR EVENT SALES TEAM:**

*event.sales@thelandmark.co.uk*

*+44 (0)20 7631 8271*