

Gazebo



Over-looking the spectacular Winter Garden Restaurant, The Gazebo can accommodate up to 250 guests and is the perfect setting for a cocktail reception. The Gazebo is open as a coffee lounge from 10.00am - 5.00pm on weekdays, but is available for private hire from 6.00pm during the week. It is also available all day on Saturdays.

| | Reception Drinks | Lunch / Dinner | Dinner / Dance | Classroom | Cabaret | Theatre | Board Room |
|----------|---------------------|-------------------|-------------------|-----------|---------|---------|---------------|
| Capacity | 350 | 120 | - | - | - | - | - |

Sample Floor Plan

Lunch / Dinner

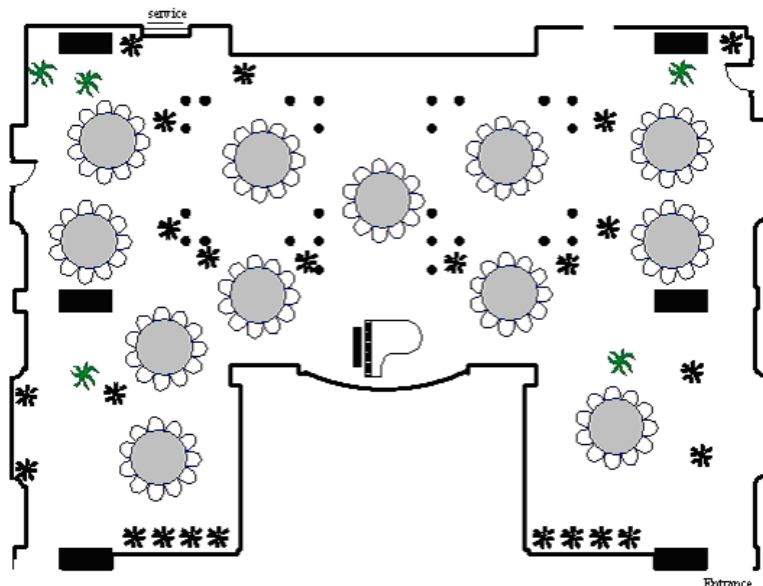

To enquire about The Gazebo please contact our Event Sales Team