

Gazebo



Over-looking the spectacular Winter Garden Restaurant, The Gazebo can accommodate up to 250 guests and is the perfect setting for a cocktail reception. The Gazebo is open as a coffee lounge from 10.00am - 5.00pm on weekdays, but is available for private hire from 6.00pm during the week. It is also available all day on Saturdays.

	Reception Drinks	Lunch / Dinner	Dinner / Dance	Classroom	Cabaret	Theatre	Board Room
Capacity	350	120	-	-	-	-	-

Sample Floor Plan

Lunch / Dinner

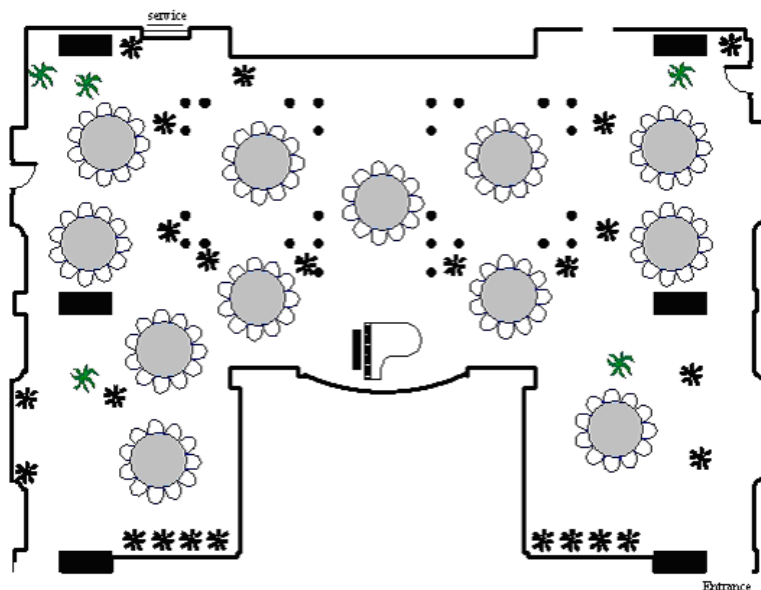

To enquire about The Gazebo please contact our Event Sales Team